

Diamond Power® HTH-8 Camera Housing

Universal High-Temperature Camera Enclosure

The Diamond Power® HTH-8 camera housing from Babcock & Wilcox (B&W) protects 1/3 in.-, 1/2 in.- and 2/3 in.-format CCD cameras from extreme heat and adverse weather conditions. Ideal for indoor or outdoor surveillance applications, the HTH-8 camera housing operates in ambient temperatures up to 200F (93C). Passages within the housing provide fast transfer of heat to the cooling medium.

- Mounts to all standard furnace mounting brackets and/or fixed and remote-controlled pan and tilt devices
- Features quick disconnect fittings for the cooling source, which can be air from a Demon III cooling device or circulating plant water



B&W's Diamond Power HTH-8 camera housing operates in ambient temperatures up to 200F.



The Demon III cooling device (an option for the HTH-8) is a compact cooler for use with high-temperature and dust-proof camera housings. It operates from plant air and can cool 100F (38C) compressed air to near freezing level. Its vortex design contains no moving parts, and with its stainless steel fabrication, can withstand most adverse environments with little to no maintenance.

HTH-8 Housing Options

Model	Description	Size	Part No.
HTH-8/L	Standard length housing for cameras with fixed lens (includes universal camera mount)	6.11 in. H x 5.85 in. W x 14.09 in. L (155 x 149 x 358 mm)	515800-3040
HTH-8/L/D	Standard length housing with Demon III cooler for camera/ fixed lens (includes universal camera mount)	6.11 in. H x 5.85 in. W x 14.09 in. L (155 x 149 x 358 mm)	515800-4040
HTH-8/LT	Standard length housing for lens tube	6.11 in. H x 5.85 in. W x 14.09 in. L (155 x 149 x 358 mm)	515800-5040
HTH-8/LT/D	Standard length housing with Demon III cooler for lens tube	6.11 in. H x 5.85 in. W x 14.09 in. L (155 x 149 x 358 mm)	515800-6040
HTH-8/LTI	Extended length housing configured for lens tube with iris and/or format converter	6.11 in. H x 5.85 in. W x 20.13 in. L (155 x 149 x 511 mm)	515800-1040
HTH-8/LTI/D	Extended length housing configured for lens tube with iris and/or format converter (includes Demon III cooler)	6.11 in. H x 5.85 in. W x 20.13 in. L (155 x 149 x 511 mm)	515800-2040
HTH-8/Z/LT	Extended length housing for lens tube	6.11 in. H x 5.85 in. W x 19.06 in. L (155 x 149 x 484 mm)	517140-1040
HTH-8/Z/LT/D	Extended length housing with Demon III cooler for lens tube	6.11 in. H x 5.85 in. W x 19.06 in. L (155 x 149 x 484 mm)	517140-2040
HTH-8/Z/L	Extended length housing for camera/lens (includes universal camera mount)	6.11 in. H x 5.85 in. W x 19.06 in. L (155 x 149 x 484 mm)	517140-3040
HTH-8/Z/L/D	Extended length housing for camera/lens with Demon III cooler (includes universal camera mount)	6.11 in. H x 5.85 in. W x 19.06 in. L (155 x 149 x 484 mm)	517140-4040
HTH-8/Z/LT/SS	Stainless steel extended length housing for lens tube	6.11 in. H x 5.85 in. W x 19.06 in. L (155 x 149 x 484 mm)	645278-0104

continued ►

Options for HTH-8 High-Temperature Housing

Option	Description	Part No.
OPTION A1	Heatshield for liquid-cooled applications	515883-1740
OPTION A2	Heatshield for Demon-cooled applications	515883-2740
OPTION B1	Insulation (external)	515884-1730
OPTION B2	Insulation (external) for HTH-8/Z housing	515884-2730
OPTION C	Heater with thermostat	515885-1740
OPTION D1	120 VAC power outlet	515886-1740
OPTION D2	24 VAC camera power	515886-2740
OPTION D3	12 VDC camera power	515886-3740
OPTION E1	Conduit fittings on rear panel for fixed lens (two fittings)	515887-1730
OPTION E2	Conduit fittings on rear panel for zoom lens (three fittings)	515887-2730
OPTION F	Inline water filter	515888-1710
OPTION G	Air curtain	517099-1740
OPTION H	Quick disconnect mating connector	515919-1310
OPTION I1	2 in. dia. pyrex window with N.D. 1 filter	700374-2020
OPTION I2	Vycor window	517092-4730
OPTION I3	Vycor window, small opening	700374-1020
OPTION K	Thermostat (N.C.)	517131-1710
OPTION M1	Rear panel for zoom lens option	517322-1730
OPTION N1	Right-angle camera mount for gauge viewing applications	517390-1130
OPTION N2	Right-angle camera mount for gauge viewing applications	517390-3130

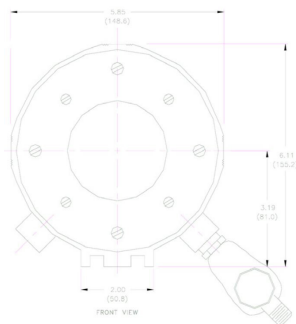

SCAN FOR MORE INFO
ON OUR WEBSITE

Babcock & Wilcox

1200 E Market Street, Suite 650
Akron, Ohio, U.S.A. 44305
Phone: +1 330.753.4511

www.babcock.com    

The information contained herein is provided for general information purposes only and is not intended nor to be construed as a warranty, an offer, or any representation of contractual or other legal responsibility.

Diamond Power is a trademark of The Babcock & Wilcox Company.



**BABCOCK
& WILCOX**

RENEWABLE | ENVIRONMENTAL | THERMAL

Established in 1867, Babcock & Wilcox is a global leader in renewable, environmental and thermal technologies and services for power and industrial applications.

For more information or to contact us, visit our website at www.babcock.com.